

RB578VAM100

Rev.A Jun.-2020

描述 / Descriptions

肖特基整流二极管，薄型 SOD-323FL 封装。

Schottky Barrier Rectifiers,SOD-323FL thin package.

特征 / Features

高可靠性，小型模具，超低 I_R ，无卤产品。

High reliability. Small mold type. Super low I_R . Halogen free product.

用途 / Applications

一般用途。

General purpose.

内部等效电路 / Equivalent Circuit



引脚排列 / Pinning



PIN	DESCRIPTION
1	Cathode
2	Anode

The recommended mounting pad size

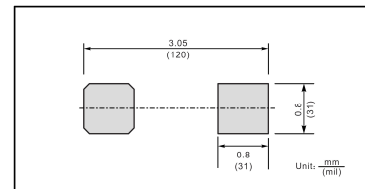

印章代码 / Marking

见印章说明。 See Marking Instructions.

极限参数 / Absolute Maximum Ratings(Ta=25°C)

参数 Parameter	符号 Symbol	数值 Rating	单位 Unit
		RB578VAM100	
Peak Repetitive Reverse Voltage	V_{RRM}	100	V
DC Reverse Voltage	V_R	100	V
Maximum Average Forward Current at Ta=25°C	I_O	0.7	A
sine-wave superimposed on rated load (JEDEC method)	I_{FSM}	25	A
Storage and Operating Junction Temperature Range	T_J, T_{stg}	-55~+125	°C

电性能参数 / Electrical Characteristics(Ta=25°C)

参数 Parameter	符号 Symbol	测试条件 Test Conditions	数值 Rating	单位 Unit
			RB578VAM100	
Maximum Instantaneous Forward Voltage	V_F	$I_F=0.7A$	0.85	V
Maximum DC Reverse Current at Rated DC Blocking Voltage	I_R	$V_R=100$	0.2	uA

电参数曲线图 / Electrical Characteristic Curve

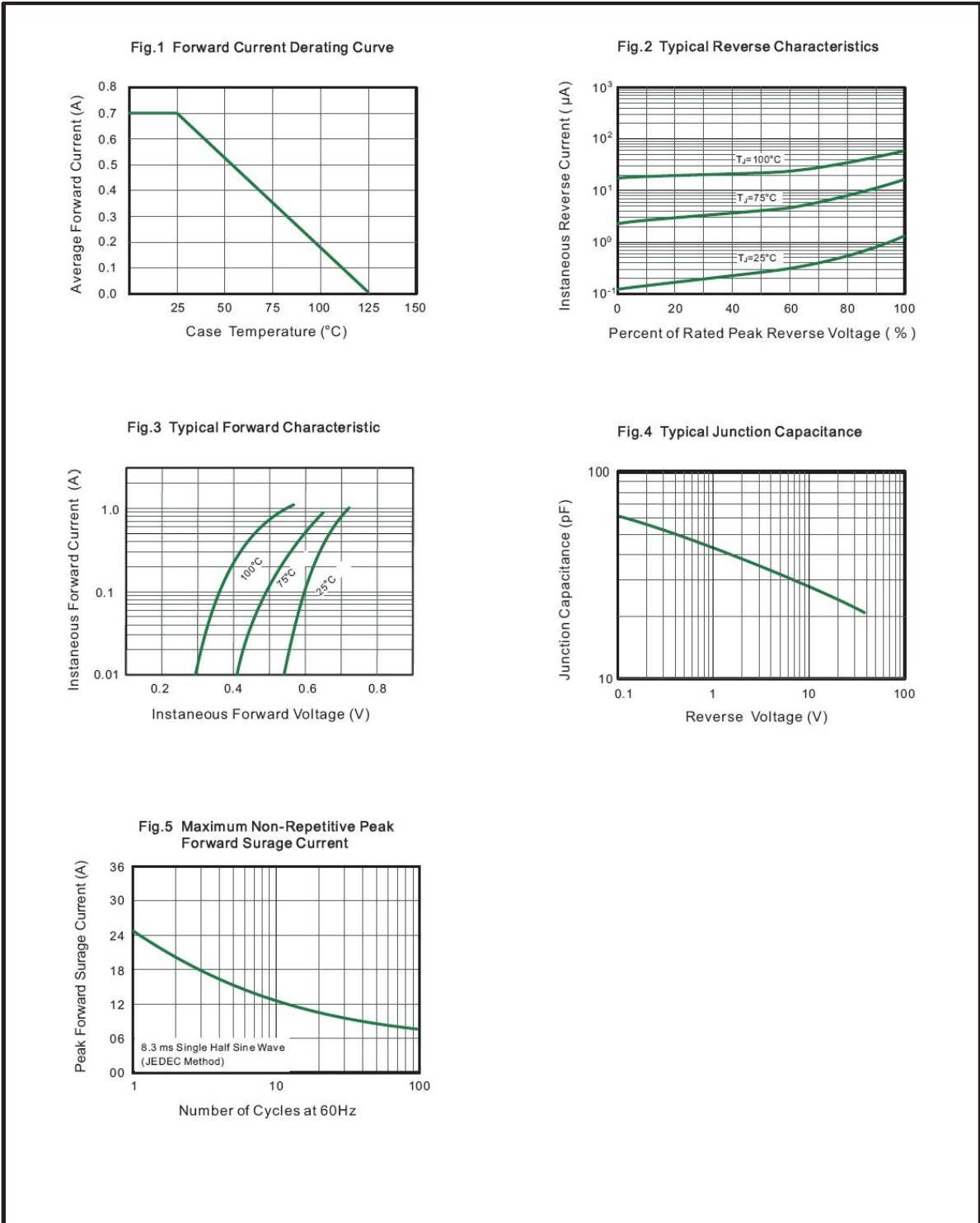

外形尺寸图 / Package Dimensions

Plastic surface mounted package; 2 leads

SOD-323FL

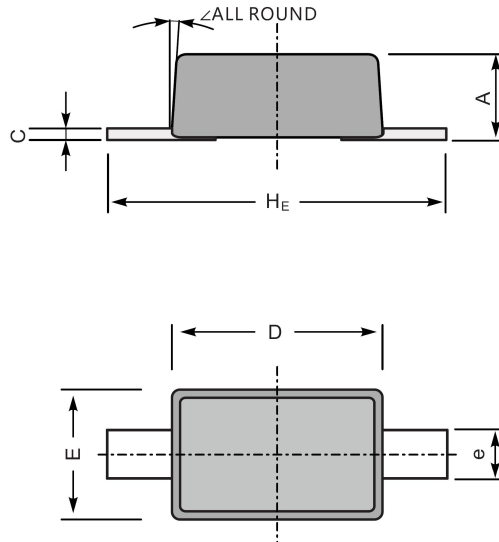

UNIT		A	C	D	E	e	H _E	z
mm	max	1.0	0.25	1.8	1.35	0.4	2.7	8°
	min	0.8	0.05	1.6	1.15	0.25	2.3	
mil	max	39	9.8	71	53	18	106	
	min	31	2.0	63	45	10	91	

印章说明 / Marking Instructions

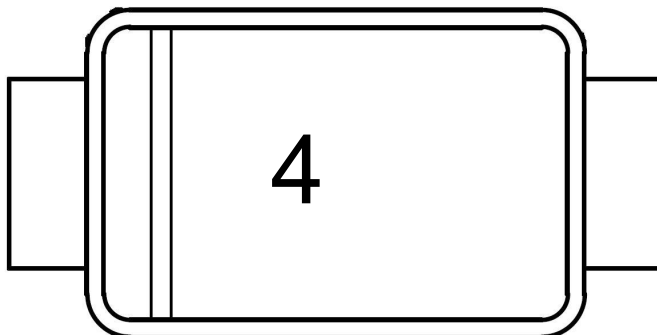

说明：

4： 为型号代码

Note:

4： Product Type Code

回流焊温度曲线图(无铅) / Temperature Profile for IR Reflow Soldering(Pb-Free)

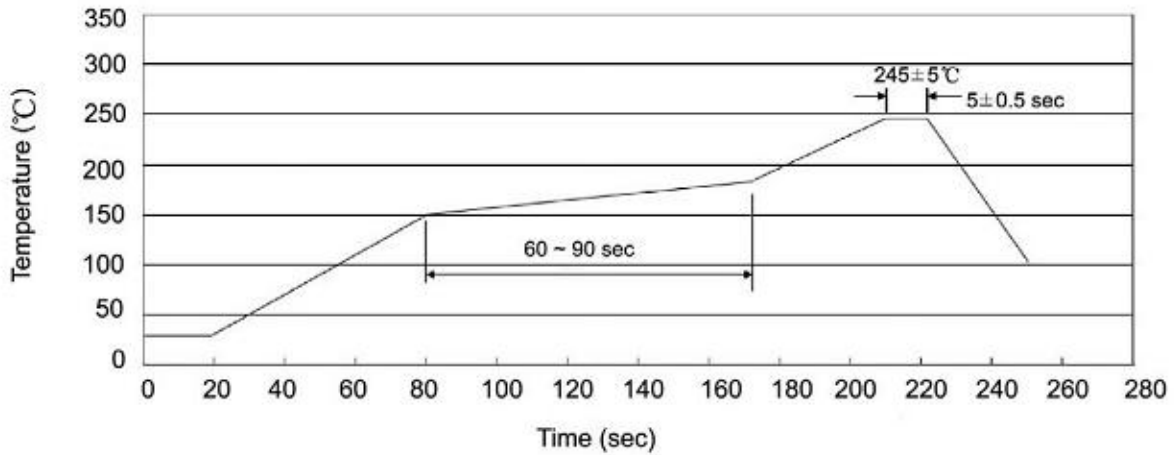

说明：

- 1、预热温度 150~180°C，时间 60~90sec;
- 2、峰值温度 245±5°C，时间持续为 5±0.5sec;
- 3、焊接制程冷却速度为 2~10°C/sec.

Note:

- 1.Preheating:150~180°C, Time:60~90sec.
- 2.Peak Temp.:245±5°C, Duration:5±0.5sec.
3. Cooling Speed: 2~10°C/sec.

耐焊接热试验条件 / Resistance to Soldering Heat Test Conditions

温度：260±5°C

时间：10±1 sec.

Temp.:260±5°C

Time:10±1 sec

包装规格 / Packaging SPEC.

卷盘包装 / REEL

Package Type 封装形式	Units 包装数量					Dimension 包装尺寸 (unit: mm ³)		
	Units/Reel 只/卷盘	Reels/Inner Box 卷盘/盒	Units/Inner Box 只/盒	Inner Boxes/Outer Box 盒/箱	Units/Outer Box 只/箱	Reel	Inner Box 盒	Outer Box 箱
SOD-323FL	3000	8	21000	6	126000	7" ×8	185X180X105	550X220X210

使用说明 / Notices